

1.1.1.

DOSASens Chlorine sensor CS4

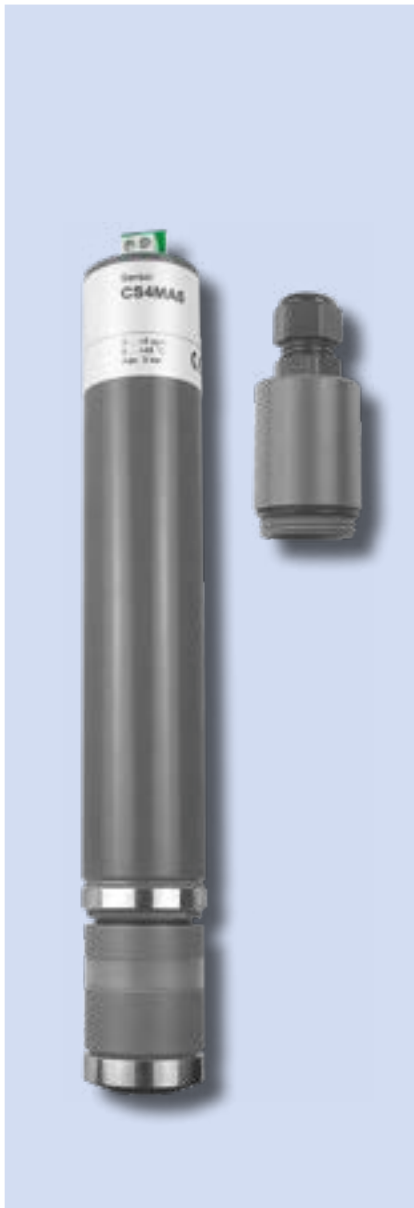

Chlorine sensor with membrane-covered, amperometric 3-electrode system. For the measurement of free inorganic chlorine with reduced pH-dependence.

Product description:

- Measurand(s): NaClO (sodium hypochlorite), Ca(OCl)₂ (calcium hypochlorite), Cl₂ (chlorine gas), electrolytically generated chlorine
- Calibration: at the controller, via analytical chlorine determination by DPD-1 method
- Interferences:
 - 75 % of ClO₂-concentration,
 - 80 % of O₃-concentration
 - combined chlorine may increase the measuring value
- pH range: 4–9
- Pressure range:
 - Operation without circlip: 0–0.5 bar, no pressure surges and/or vibrations
 - Operation with circlip: 0–3.0 bar, no pressure surges and/or vibrations
- Temperature range: 0–45 °C
- Integrated automatic temperature compensation
- Response time: T₉₀ approx. 2 min.
- Absence of the disinfectant: max. 24 h
- Flow rate: approx. 15–30 l/h, low flow-dependence
- Shaft length: standard 175 mm, and up to 220 mm in length (mA-Version)
- Connection: standard 4-pole plug; for mA-version 2-pole terminal, M12 male or Modbus RTU with M12 male
- Material: PVC-U, PEEK, stainless steel 1.4571, microporous hydrophilic membrane

Areas of application:

- Swimming pool, drinking water, surfactants are partially tolerated.

Scope of supply:

- DOSASens CS4 sensor, membrane cap, electrolyte, operating manual

Ordering data:

Type:	Measuring range: ppm	Resolution: ppm	Output signal:	Power supply:	Item number:
CS4H-M12	0.005–2.00	0.001	0 to -2000 mV 1 kΩ	±5 to ±15 VDC 10 mA	3626040
CS4N-M12	0.05–20.00	0.01			3626041
CS4L-M12	0.50–200.0	0.1			3626042
CS4H-An-M12	0.005–2.00	0.001		9–30 VDC 20–56 mA	3626050
CS4N-An-M12	0.05–20.00	0.01			3626051
CS4L-An-M12	0.50–200.0	0.1			3626052
CS4H-M0c	0.005–2.00	0.001	ModBus RTU	3426360	
CS4N-M0c	0.05–20.00	0.01		3426361	
CS4L-M0c	0.50–200.0	0.1		3426362	

Ordering data:

Type:	Measuring range: ppm	Resolution: ppm	Output signal:	Power supply:	Item number:
CS4MA2	0.01 – 2.00	0.01	4 – 20 mA	12 – 30 VDC R _L = 50 – 900 Ω	3426303
CS4MA5	0.01 – 5.00	0.01			3426304
CS4MA10	0.01 – 10.00	0.01			3426305
CS4MA20	0.01 – 20.00	0.01			3426306
CS4MA200	0.50 – 200.0	0.10			3426307
CS4MA2-M12	0.01 – 2.00	0.01			3426313
CS4MA5-M12	0.01 – 5.00	0.01			3426314
CS4MA10-M12	0.01 – 10.00	0.01			3426315
CS4MA20-M12	0.01 – 20.00	0.01			3426316
CS4MA200-M12	0.50 – 200.0	0.10			3426317

Additional technical data:

Type:	Slope:	Connection:	Special characteristics:
CS4H-M12	-1000 mV/ppm	M12 female	Connection only to a controller with galvanically separated power supply.
CS4N-M12	-100 mV/ppm		
CS4L-M12	-10 mV/ppm		
CS4H-An-M12	-1000 mV/ppm		
CS4N-An-M12	-100 mV/ppm		
CS4L-An-M12	-10 mV/ppm		
CS4H-M1c	Modbus RTU	M12 female	Connection only to a controller with galvanically separated power supply.
CS4N-M1c			
CS4L-M1c			
CS4MA2	8.0 mA/ppm	2-pole terminal	
CS4MA5	3.2 mA/ppm		
CS4MA10	1.6 mA/ppm		
CS4MA20	0.8 mA/ppm		
CS4MA200	0.08 mA/ppm		
CS4MA2-M12	8.0 mA/ppm	M12 female	
CS4MA5-M12	3.2 mA/ppm		
CS4MA10-M12	1.6 mA/ppm		
CS4MA20-M12	0.8 mA/ppm		
CS4MA200-M12	0.08 mA/ppm		

Spare parts:

Spare parts:	for sensor type:	Item number:
Membrane cap M48.4E	CS4 all types	9026023
Electrolyte ECS2.1	CS4 all types	9026060

Accessories:

Type:	for sensor type:	Item number:
Sensor simulator pH, Redox, Cl	all sensors with mV signal	21131100
Sensor simulator SIM11.1n	0 mV, -100 mV, -1000mV	9026205
Sensor simulator 4 – 20 mA, current sensor	all sensors with mA signal	90249000
mV Simulator and mA Tester	all sensors with mV signal or mA signal	21131105
Photometer for calibration	chlorine, total chlorine, isocyanuric, pH	90231000